

## CAPITOL COMPLEX

- |   |  |   |
|---|--|---|
| <p>CCC Capitol Complex Child Care Center<br/>         CVC Capitol Visitors Center<br/>         CDO Capitol District Office<br/>         CSB Central Services Building<br/>         DCG Dewitt C. Greer<br/>         EOT Ernest O. Thompson<br/>         ERS Employee Retirement System<br/>         EXT Capitol Extension (Underground)<br/>         GM Governor's Mansion<br/>         JER James Earl Rudder</p> | <p>JHR John H. Reagan<br/>         LBJ Lyndon B. Johnson<br/>         LIB Lorenzo de Zavala State Archives and Library<br/>         PDB Price Daniel Sr. Building<br/>         REJ Robert E. Johnson<br/>         SCB Supreme Court Building<br/>         SFA Stephen F. Austin<br/>         SHB Sam Houston Building<br/>         SIB State Insurance Building<br/>         SIBX State Insurance Building Annex</p> | <p>TCC Tom C. Clark<br/>         TJR Thomas Jefferson Rusk<br/>         TRS Teacher Retirement System<br/>         THC Texas Historical Commission<br/>         TSHM Bob Bullock Texas State History Museum<br/>         TWC Texas Workforce Commission<br/>         TWCX Texas Workforce Commission Annex<br/>         TLC Texas Law Center<br/>         WBT William B. Travis<br/>         WPC William P. Clements, Jr.</p> |
|---|--|---|

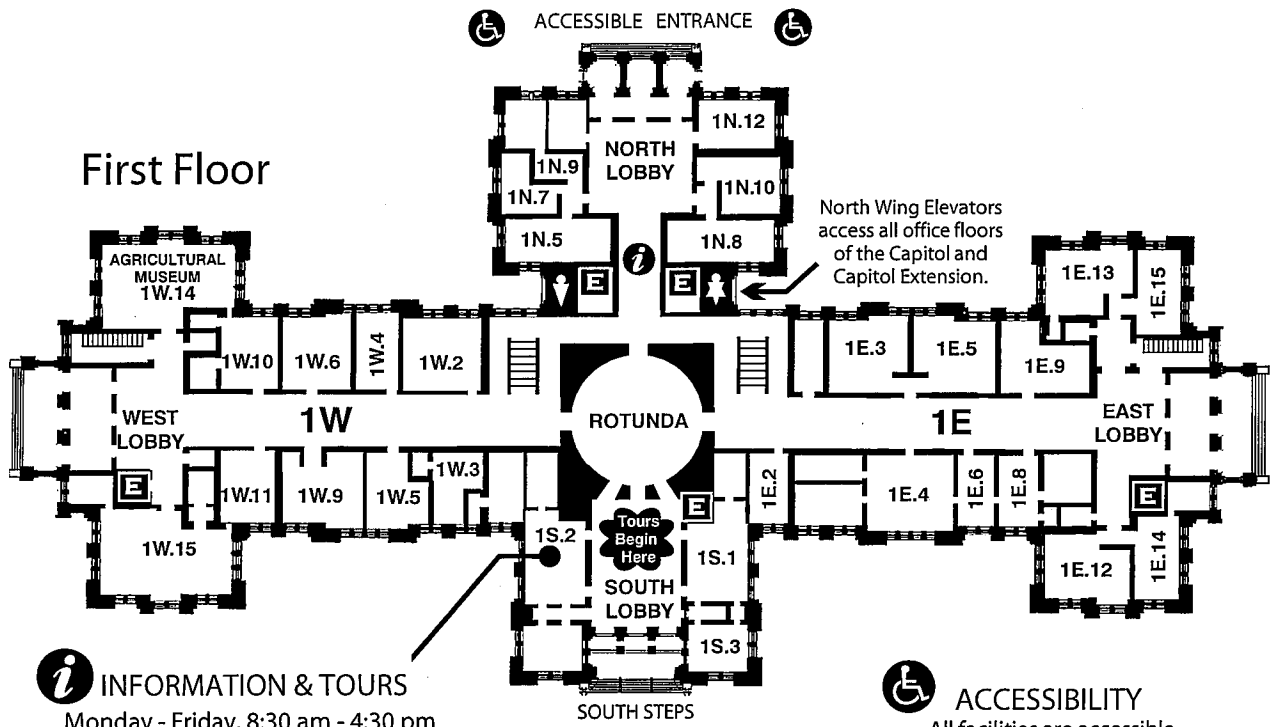

**i INFORMATION & TOURS**  
 Monday - Friday, 8:30 am - 4:30 pm  
 Saturday 9:30 am - 3:30 pm  
 Sunday, Noon - 3:30 pm  
 Call 463-0063 for more information

**♿ ACCESSIBILITY**  
 All facilities are accessible  
 to persons with disabilities.  
 For assistance call 463-0063.

**Ground Floor  
 (Basement)**

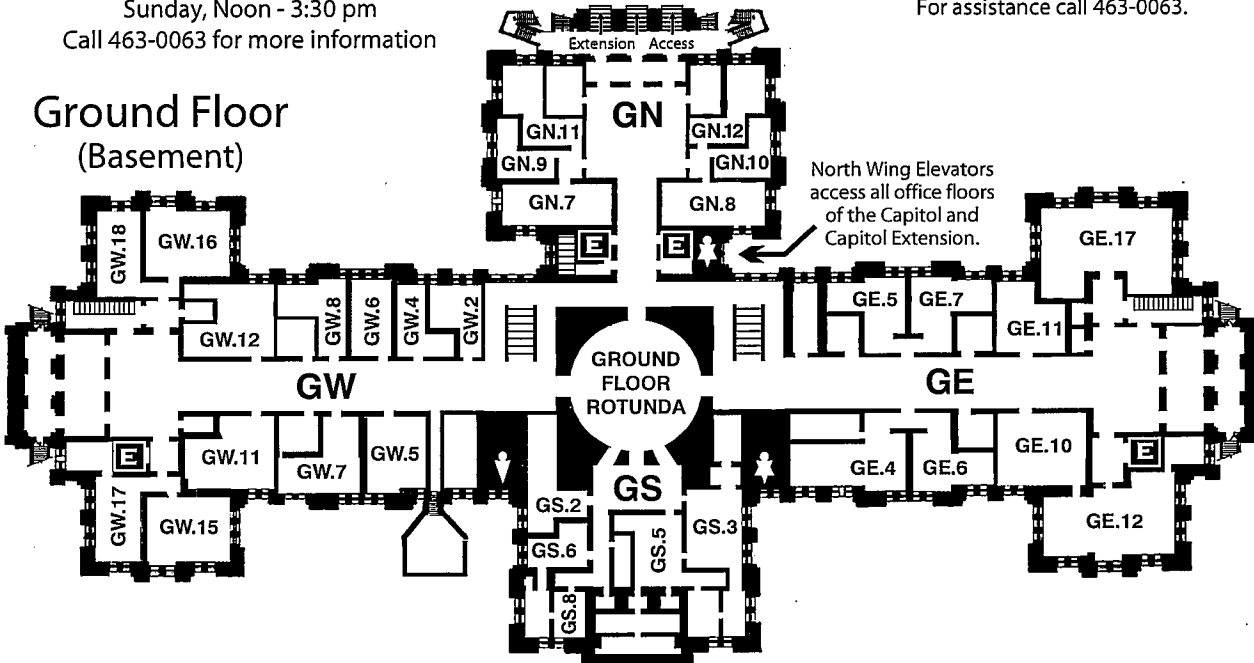

**CAPITOL BUILDING GUIDE  
 FLOORS 1 & GROUND**

## Second Floor

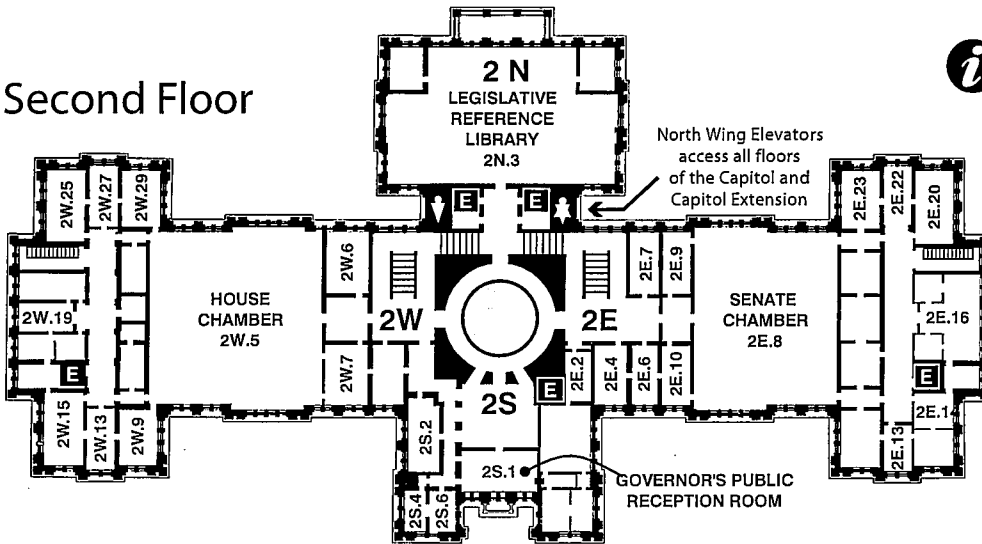

### INFORMATION & TOURS

Monday - Friday, 8:30 am - 4:30 pm  
 Saturday, 9:30 am - 3:30 pm  
 Sunday, Noon - 3:30 pm  
 Call 463-0063 for more information

Capitol Extension Access: Take the North Wing elevators to Floor E1 or E2 of the underground Capitol Extension. Please visit the Capitol Giftshop on Floor E1 for Texas and Capitol mementos and books, as well as mints, medicines, and other sundries. Also located on level E1 are a public cafeteria, an Automatic Teller Machine (ATM) and vending machines.

## Fourth Floor

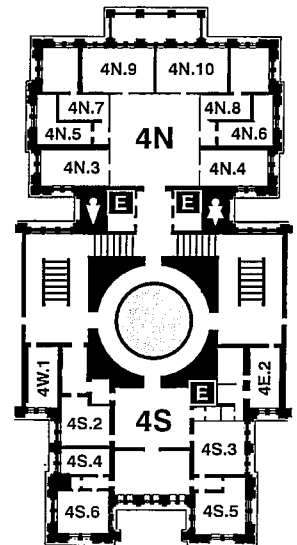

## Third Floor

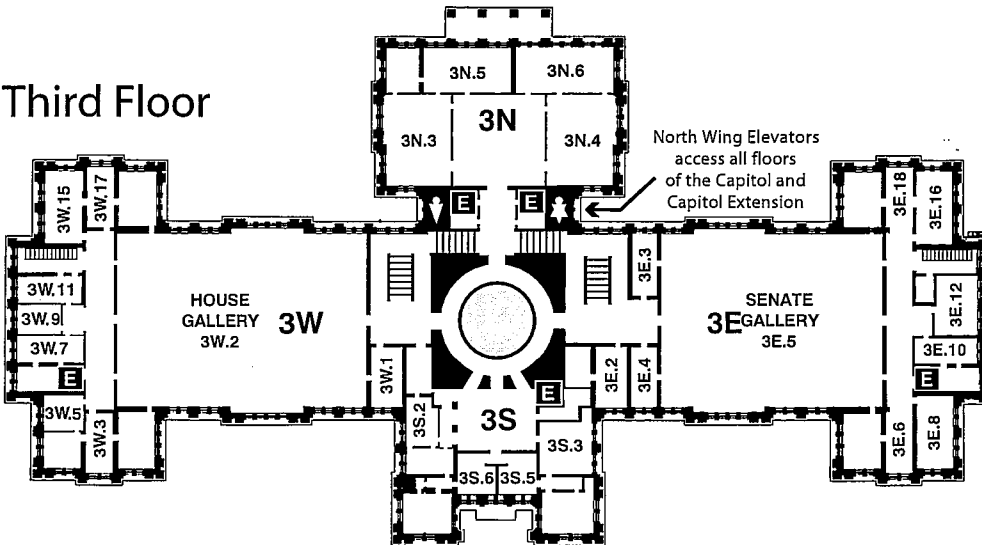

### ACCESSIBILITY

All facilities are accessible to persons with disabilities. For assistance call 463-0063.

# CAPITOL BUILDING GUIDE

## FLOORS 2, 3, & 4

# Extension First Floor (E1)

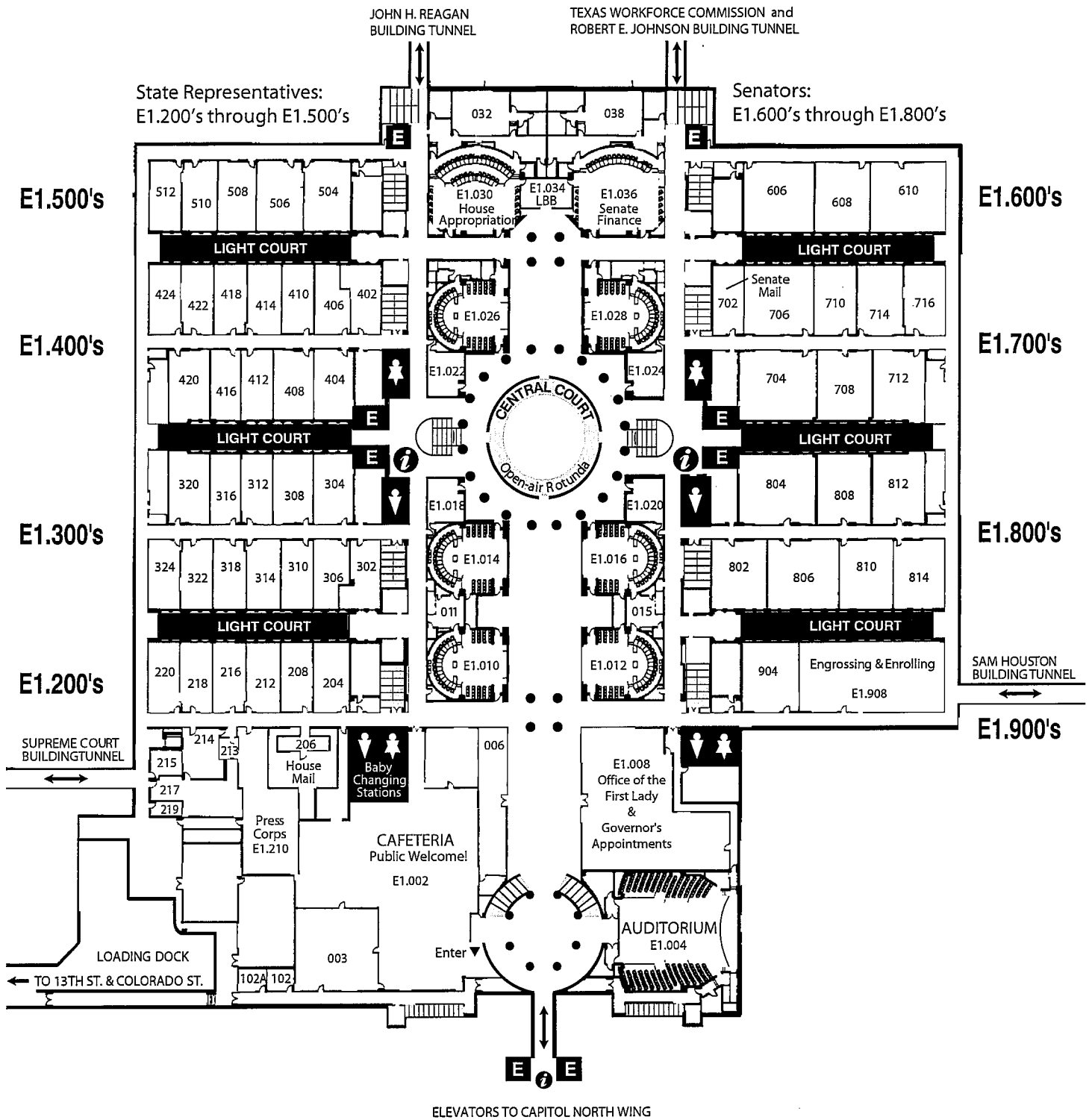

## Capitol Extension Guide Floor E1

# Extension Second Floor (E2)

State Representatives Offices  
E2.200 through E2.900's

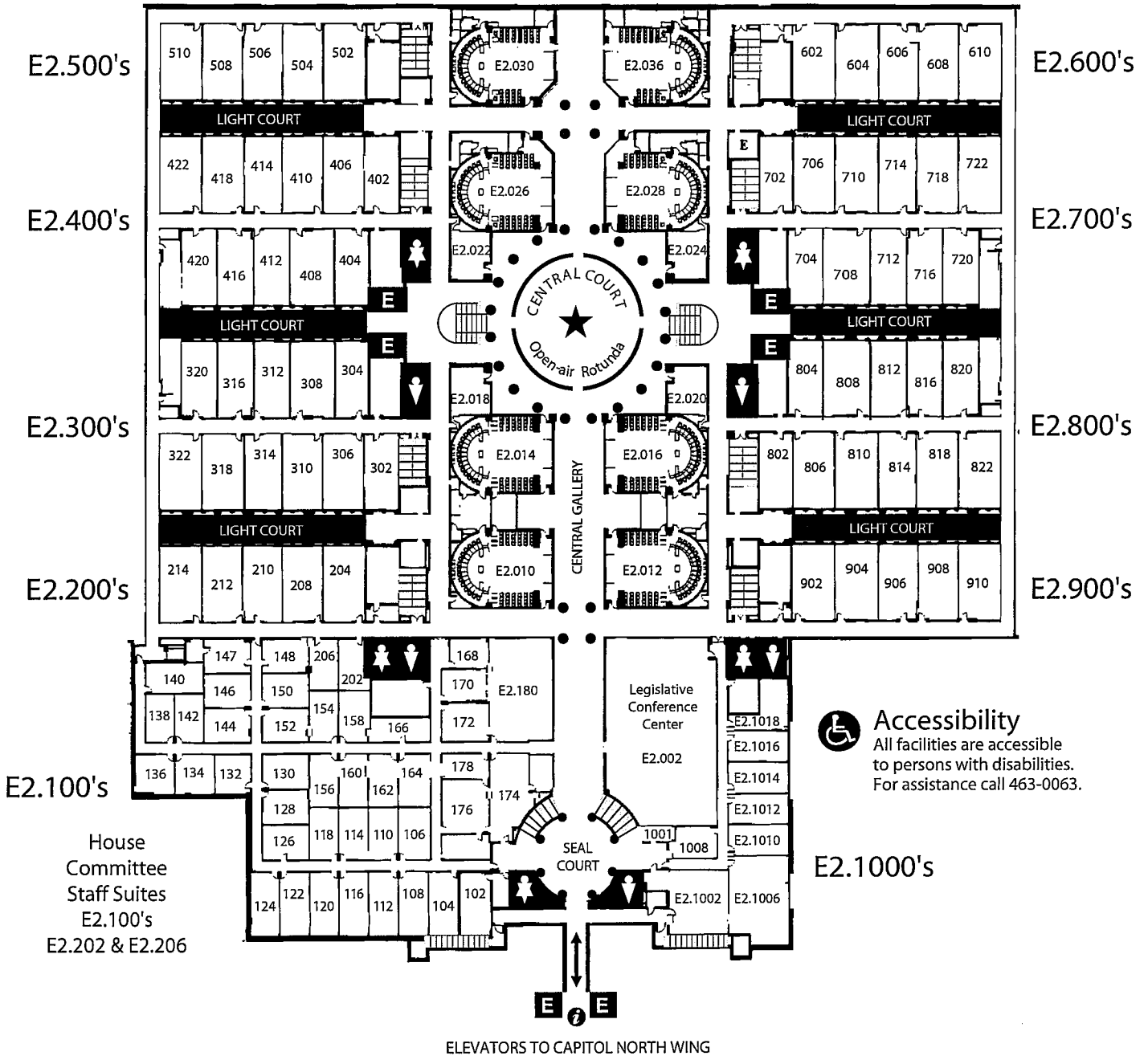

## Capitol Extension Guide Floor E2